

# Installation instructions accessory Compleo eSMARTMETER

Tip: A detailed description of how to integrate the eSMARTMETER can be found in the installation manual Compleo eCLICK.

# Safety information



## Danger

Handling live components incorrectly may cause grievous injuries and death. So heed at all times the five safety rules under DIN VDE 0105:

- Disconnect from all power sources
- Lock against reactivation
- Verify zero voltage (all poles)
- Earth and short circuit
- Cover or partition-off adjoining live parts



## Important

Keep equipment pack away from small children. There is a risk that small parts could be swallowed by children, resulting in death. Do not install in the presence of children.



## Important

Make sure that all components are dry during installation.

## Qualifications for electrical work

These installation instructions are intended for specialised electricians. The eSMARTMETER may be installed by qualified, specialised electricians only.

The specialised personnel performing or supervising the electrical installation and maintenance of the device must have read and must follow these installation instructions. Also, this personnel must have been assigned by the system owner.

## Germany

Applicable are the requirements under DGUV Regulation 3 or DIN VDE 0105-100:

- Technical training (electrical installations)
- Knowledge and experience in the assigned field of work
- Knowledge of the pertinent standards
- Ability to assess the assigned work
- Ability to recognise dangers

## Austria

Applicable are the requirements under ÖVE/ÖNORM EN 50110-1:

A specialised electrician is a “person who has undergone suitable technical training and has the knowledge and experience to recognise and prevent the potential dangers of electricity”.

## Switzerland

Applicable are the requirements under NIV, SR 734.27:

“Section 2: Approval for installation work, Subsection 1: Compulsory approval, Art. 6

Persons assigned to install, modify, or repair electrical installations, hardwire electrical products to electrical installations, or disconnect, modify, or repair such connections must first be approved by the Inspectorate.

Subsection 2: General installation approval, Art. 7 – Approval for natural persons

Natural persons performing installation work on their own responsibility are granted general installation approval when:

- b) their training corresponds to the state of the art and their continued training is assured; and
- c) they can furnish verification that they obey the regulations under this ordinance.”

# Installation

## Included in delivery

1 eSMARTMETER  
1 patch cable

**Wiring cable not included. Insert a cable with a maximum cross-section of 10 mm<sup>2</sup>.**

## Integrating the Compleo eSMARTMETER

Remove the contact guard from the eCLICK (cf. previous page). It will be placed back on the eCLICK at the end of the installation.

When delivered, the contact guard is snapped to four points on the eCLICK.

### 01

Push the eSMARTMETER into the marked position, and click it in.

### 02

Insert the loose ends of the pre-assembled cables into the top section of the eCLICK (mains board).

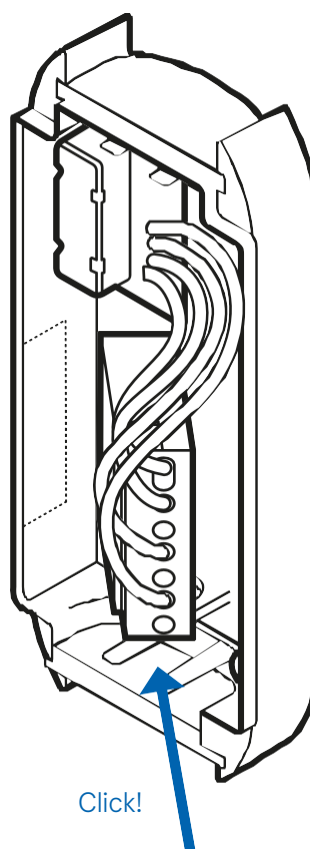

## Supply cable connection

There are two connection options for the supply cable. The two options for single and double supply can be found in the installation manual Compleo eCLICK.

## Compleo eSMARTMETER cabling

As the last step before installation, eSMARTMETER cabling must be carried out.

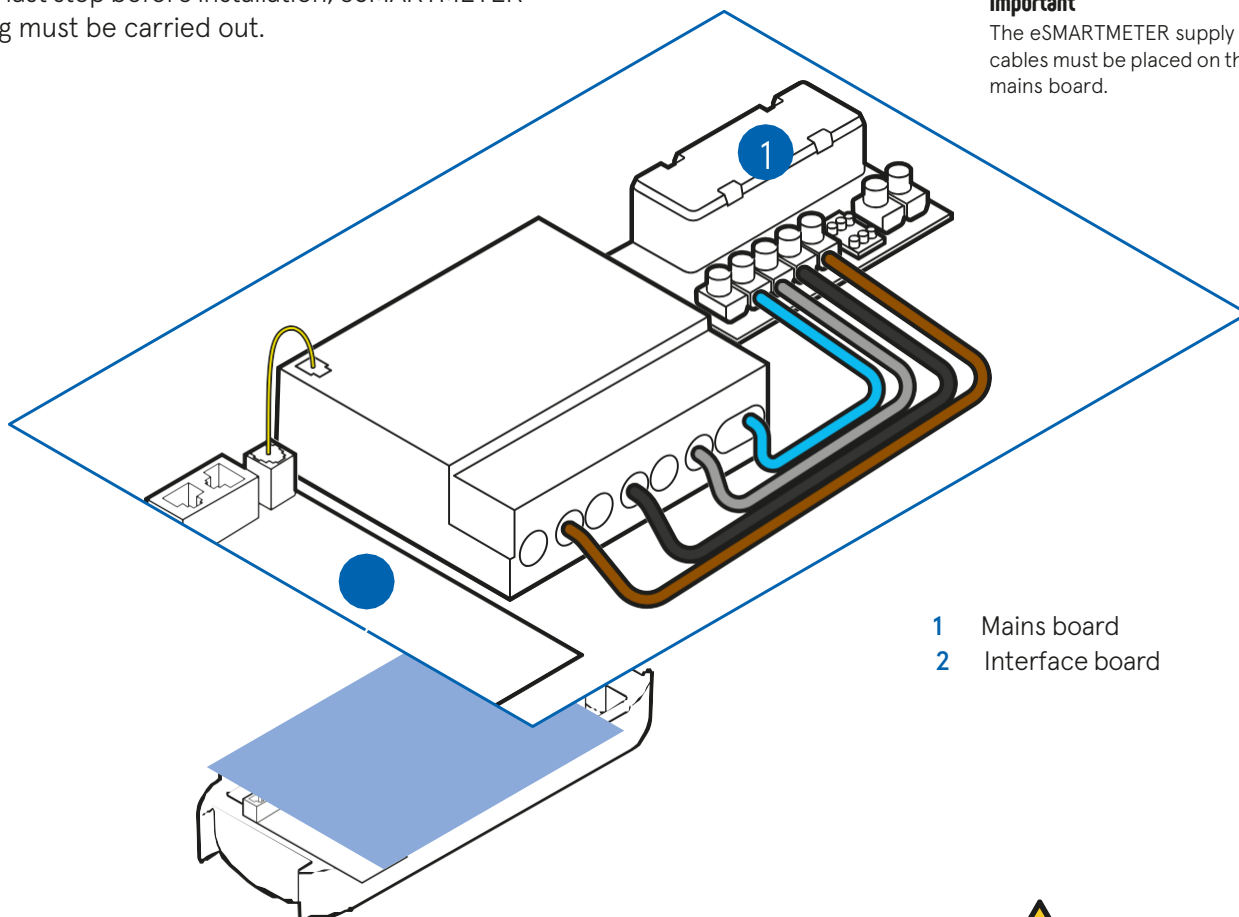

### Important

The eSMARTMETER supply cables must be placed on the mains board.

- 1 Mains board
- 2 Interface board

### 01

Consult the figure to wire the eSMARTMETER to the mains board, and tighten the screws with a torque of 1.2-1.5 Nm.

### 02

Use the provided data cable to connect the eSMARTMETER to the interface board.



### Danger

Make sure that the fusing for the circuits has been disconnected and there is no voltage across the fitted components.

### Certificates



As of: 08/2023  
Document Center:

**Compleo Charging Solutions GmbH & Co. KG**  
Ezzestraße 8  
44379 Dortmund | Germany  
servicedesk@compleo-cs.com  
compleo-charging.com

**Vertriebspartner UK**  
Compleo Charging Solutions UK Ltd.  
The Lambourn | Wyndyke Furlong  
Abingdon | OX14 1UJ | Great Britain

